

MCH-630

MCV-720

**TRAVELING COLUMN VERTICAL
MACHINING CENTER**

MCV-1020A

DMV-2000

MCV-1020BA

MCV-1250

MCV-1450

MCV-1700

MCV-2100

MCV-2600

DCM-2213



DAH LIH MACHINERY INDUSTRY CO., LTD.

No. 3, Kung-Yeh Lane, Fengcheng Road, Nanshih Tsun,
Wufeng Shiang, Taichung Hsien, 413, Taiwan.

TEL:886-4-23334567 FAX:886-4-23307567

E-mail:export.sale@dahlih.com.tw Http://www.dahlih.com.tw

022-D2-00-017

1000.02.2009

The Latest and Best Quality Machinery.

DAHLIH®

DAHLIH DMV-2000

Traveling Column Vertical Machining Center

3-axis Traveling Column!
All New Design Concepts, Unique Performance!
Upgraded Accuracy and Performance!

- » Traveling column on three axes.
- » Linear ways on three axes.
- » Three linear ways on X-axis.
- » Inserted type rotary table (4th axis) (optional)
- » Servo motor drives X-axis nut with fixed ball screw to eliminate screw oscillation problem.
- » 32 tools chain type magazine.
- » Moving control box.
- » Self-lubricated linear ways and ball screws.
- » Rapid traverse on X, Y, Z-axis 40 x 40 x 30 m/min.



DMV-2000

Unique Machine Structure Design!

A Perfect Combination of Rigidity and Stability

Nut Rotates Screw Fixed

- » The X-axis transmission system employs a servo motor to drive nut, and the ball screw is fixed, under a longer travel condition, this special design may eliminate the ball screw oscillation problem when it runs at high speed.

32 Tools Chain Type Tool Magazine

- » The magazine rotation is driven by a cylindrical cam. Bi-directional random tool selection provides highly efficient tool changing.
- » The magazine is separately mounted combined with an auto door to prevent tool from contamination by chips or coolant.

- » X-axis is mounted with 3 heavy duty linear ways, providing a solid support for column.
- » The rigid headstock construction provides outstanding cutting capability.
- » The traveling column structure and fixed table design ensures the machine travel is not affected - regardless of workpiece weight variation. This results in consistent accuracy at all times.

Self-lubricated Linear Ways & Ball Screws

- » The three axes linear ways and ball screws are lubricated by specially designed self grease-lubrication devices. The operator is not required to add lubrication oil. This special lubrication system not only prevents oil deterioration caused by coolant pollution, but also meets environmental protection requirement.

Coolant Through Ball Screw (Option)

- » Coolant through ball screws on the three axes effectively prevents thermal growth while ensuring highly accurate machining.

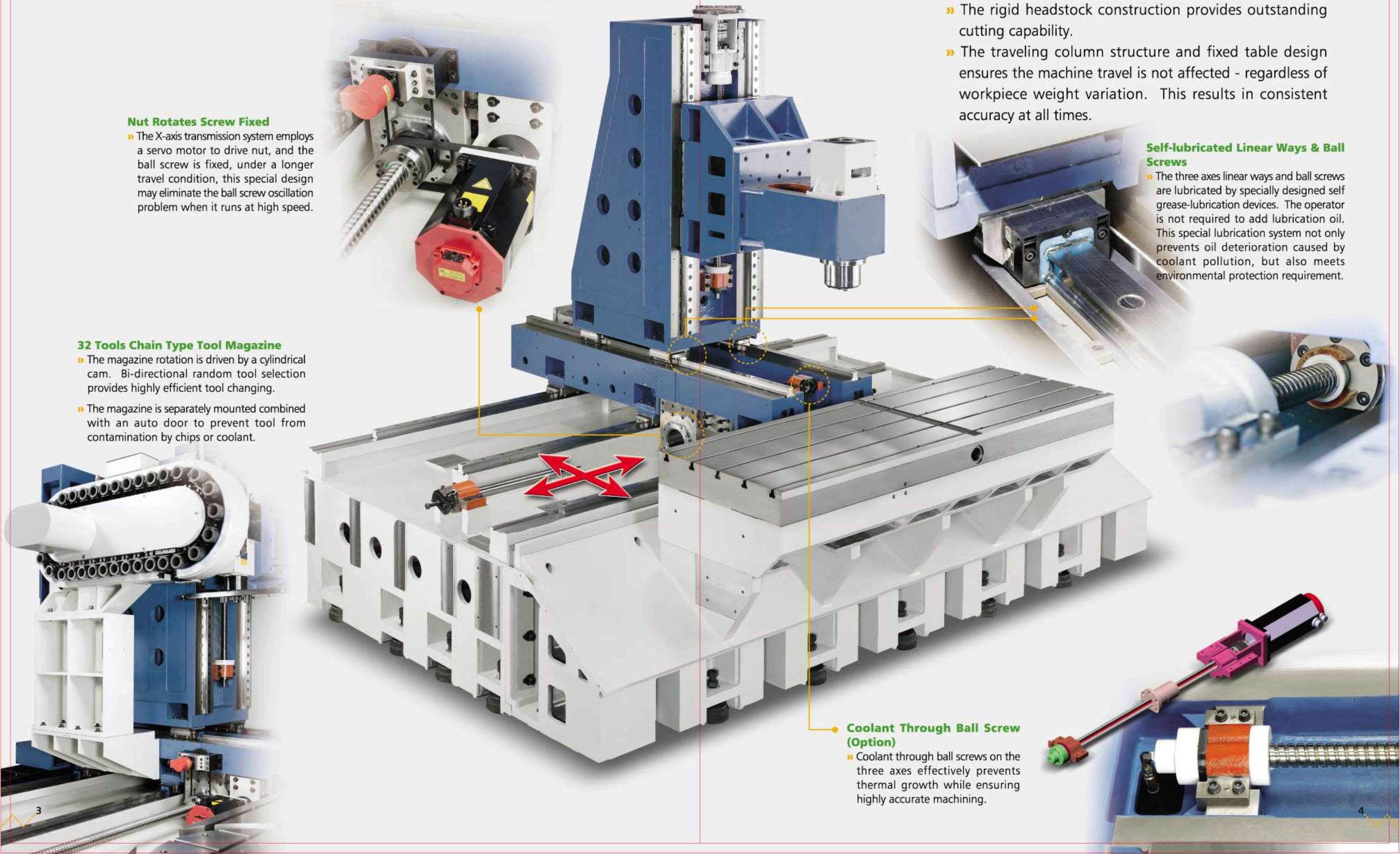

Direct Drive Spindle

Designed and Engineering with Speed and Precision in Mind!

**Dah Lih's All New DMV-2000...
A Precise Performer with
Advanced Control.**

ACC/DEC Speed Control
High Precision Contour Control
Quadrant Change Offset
Data Server



**High Speed
High Precision**

Vibration Dampening

Nurbs Interpolation

High Speed Spindle

High Torque Servo Drive System

Extremely Rigid Structure

12,000 RPM Direct Drive Spindle (Option)

10,000 / 15,000 RPM Direct Drive Spindle (Optional)

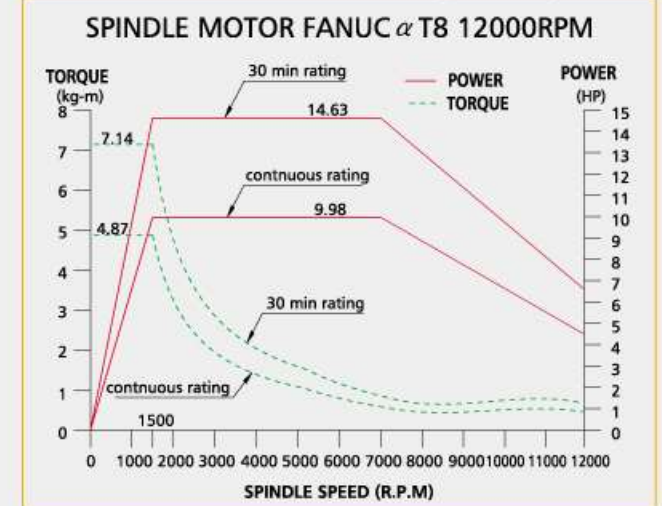

15,000 RPM Built-in Type Spindle (Optional)

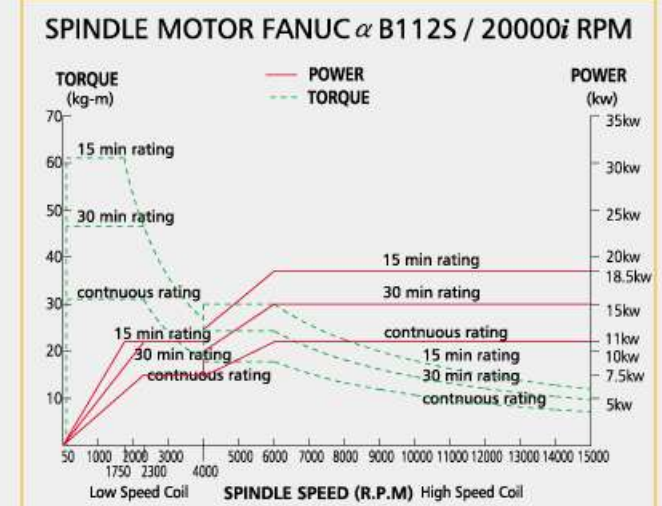

Extra Long Table

- » The fixed type extra long table measures 2100 x 700 mm, making it suitable for loading slender with long workpiece.
- » The table can be divided into two areas, featuring twin-table function. It saves spindle's waiting time during loading and unloading workpiece, while increasing machining efficiency.

Inserted Type Rotary Table (4th Axis) (Option)

- » Exclusively designed inserted type rotary table makes the machine suitable for flexible parts machining, and saves space.
- » The rotary table is driven by a servo motor combine4d with the use of external encoder to guarantee high indexing accuracy.

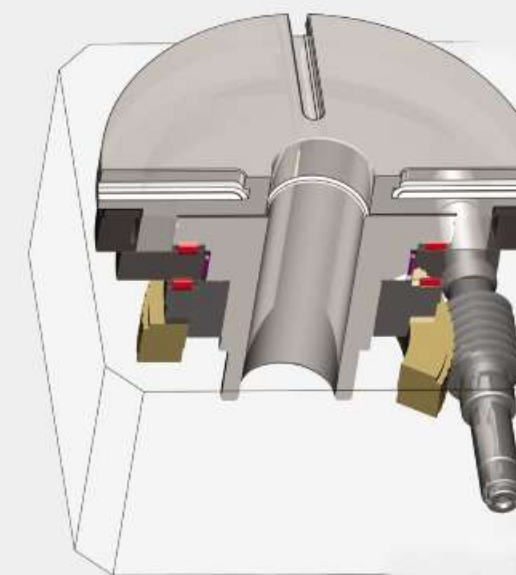



LATEST ADVANCED CNC CONTROLLER

Moving control box: The control box is moved on precision linear ways to right and left. This combined with 180° swing of control box provides increased convenience of operation.

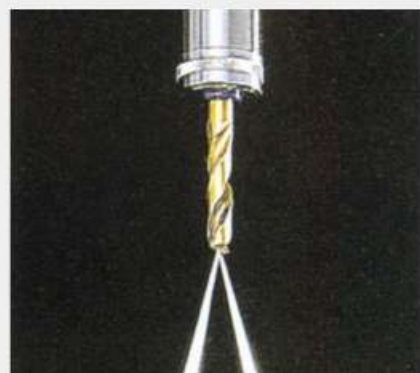

COOLANT THROUGH SPINDLE DEVICE



AUTOMATIC TOOL LENGTH MEASURING DEVICE (RENISHAW or BLUM)



AUTOMATIC WORKPIECE MEASURING DEVICE



Fanuc Oi-MD
CNC Control
(Standard Equipment)



SPINDLE COOLER

The spindle cooler ensures machining accuracy and efficiency.



